

REPAIRING 2G AND FOLD DOWN FLOATING FLOORS

Replacing a damaged plank – Option A

If you choose to uninstall all the planks until you reach the damaged one, please consider the instructions on how to uninstall a 2G and Fold Down planks.

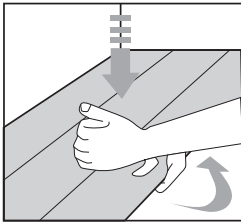

Lift the planks a few centimeters and tap along the joint.

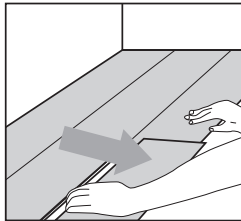

The released plank can then be pulled out. However, never bend installed planks backwards, as this will damage the planks.

Replacing a damaged plank – Option B

If you choose to remove only the damaged plank, please consider the following instructions.

The following tools and materials are required in order to remove a plank from an installed area:

Electric handsaw, knife, chisel, hammer, adhesive (PVA adhesive, class D3).

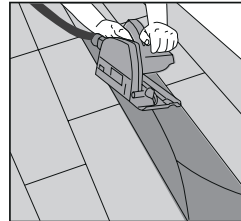

To remove the damaged plank you must cut it with a circular saw. Set the saw to the precise depth of the plank to prevent from cutting the PE film or even the subfloor. If you accidentally cut the PE film, cover it by insert a new piece and use adhesive tape to unite them. Follow the cutting pattern as in the image.

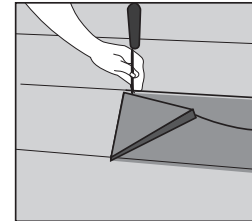

Use a wood chisel to remove one piece from a top.

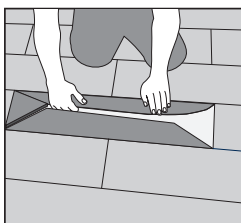

1 Remove the remaining short and long side pieces. Be caution while removing, not to damage the adjacent planks.

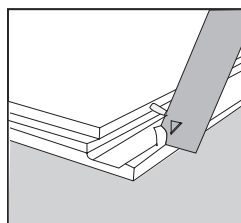

2 With a wood chisel, cut off the tongue on the short and long sides of the adjacent installed planks.

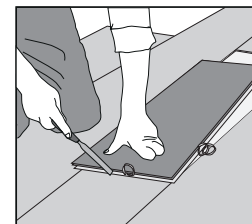
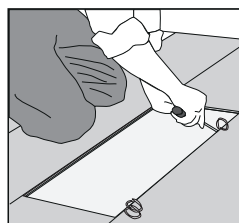

3 Repeat the cutting of the tongue (on the short and long sides) on the new plank.

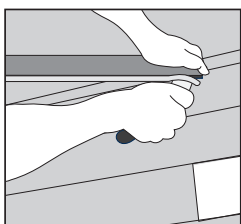

4 Cut off the locking groove rebound on the short and long sides of the new plank.

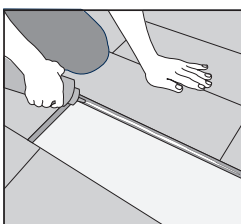

5 Apply a PVA D3 class adhesive on the short and long sides where you have cut the tongues. Apply on the adjacent installed planks, as well as on the new plank.

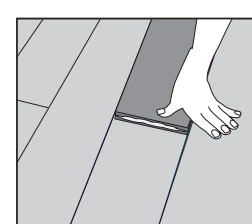
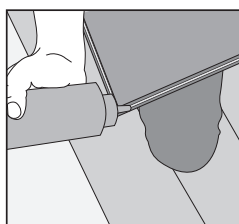

6 Slide the new plank into the place by inserting the side with the groove first, using only manual pressure.

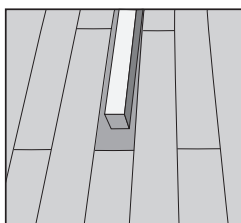

7 Cut off the locking groove rebound on the short and long sides of the new plank.